

Notification – Central Station

9 December 2021

Sydney Metro is Australia's biggest public transport project.

Services started in May 2019 in the city's North West with a train every four minutes in the peak. Metro rail will be extended into the CBD and beyond to Bankstown in 2024. There will be new CBD metro railway stations at Martin Place, Pitt Street and Barangaroo and new metro platforms at Central.

In 2024, Sydney will have 31 metro railway stations and a 66 km standalone metro railway system – the biggest urban rail project in Australian history. There will be ultimate capacity for a metro train every two minutes in each direction under the Sydney city centre.

Laing O'Rourke is delivering the new Sydney Metro platforms under Central Station as well as the landmark Central Walk - a new underground pedestrian concourse to help customers get around Sydney's busiest railway station.

Work at 20-28 Chalmers Street*

Temporary partial road closure — Randle Lane, Surry Hills

The construction of the new entrance to Central Station at 20-28 Chalmers Street is continuing. To enable power for Sydney Metro, steel and concrete modules will be installed within the Chalmers Street site from Randle Lane. Due to the size of the modules, delivery and installation will require a temporary partial closure of Randle Lane.

The partial closure will occur **from 3am on Monday 20 December to 6pm on Thursday 23 December 2021**. (weather permitted). [See map overleaf](#).

Two trucks will deliver large modules **between 3am and 5am on Monday 20 December**. Contingency date is Tuesday 21 December (3am-5am). The modules will be unloaded using the crane.

What to expect

- Randle Lane will temporarily be two-way for local traffic only.
- Due to the nature of the work, some of these activities may be noisy. To reduce impacts to nearby residents, activities will be minimal in the early hours of Monday 20 December and Tuesday 21 December
 - High-impact noise and vibration activities are only permitted Monday to Friday (8am-6pm) and Saturday (8am-1pm).
- Machinery used during this work include: tower crane and oversized trucks along with hand and power tools.

Access

- Randle Lane will temporarily be two-way for local traffic only. Access and egress will be available from the north via Elizabeth Street, or from the south, via Randle Street.
 - Access to private properties and emergency exits onto Randle Lane will be maintained at all times.
 - Please follow the signage and directions of traffic control in the area.
 - Other road users should avoid Randle Lane and follow the directions of traffic control at all times.
- Randle Lane will be closed to pedestrians and cyclists. Please use the pedestrian / cyclist diversion in place.
- Traffic control will be located at both entrances to Randle Lane to safely guide local traffic, pedestrians and other road users around the work.
- Some construction vehicles will move into and around Randle Lane for delivery and concreting purposes.

* While construction activities within the Central Station precinct are already permitted 24/7 for haulage/deliveries, excavation and station fitout, as well as works scheduled during rail shutdown weekends, the extension of construction working hours under the Environmental Planning and Assessment (COVID-19 Development – Construction Work Days) Order (no.2) 2021 to 7am-6pm Monday - Sunday including public holidays (including the Sydney Metro site at 20-28 Chalmers Street) is in effect. There will be no change to high-impact noise and vibration activities, which are still only permitted Monday to Friday (8am-6pm) and Saturday (8am-1pm).

Thank you for your cooperation while we complete this essential work.

Work area – Surry Hills

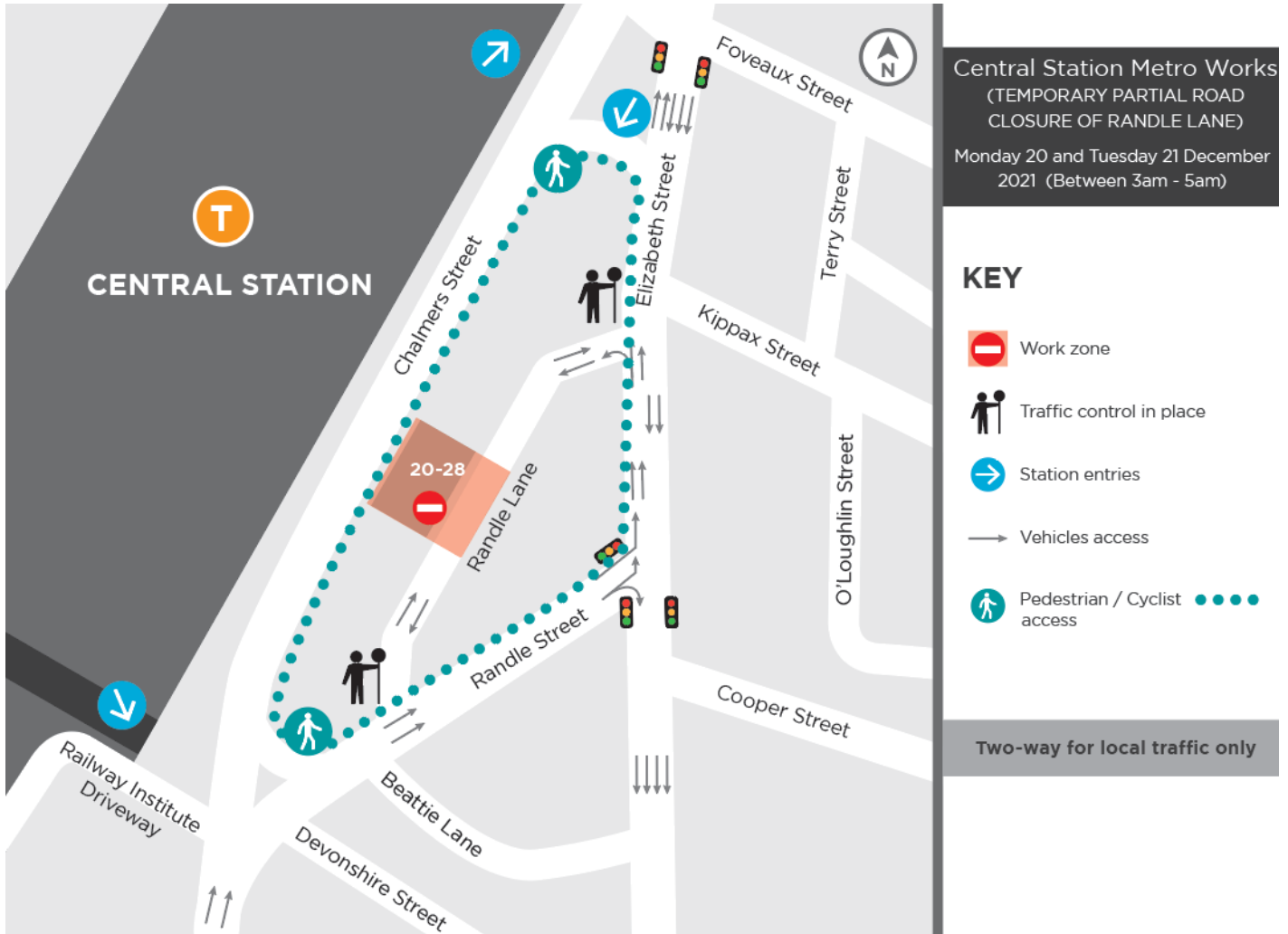

SMCSWCSM-LOR-SMC-CL-COM-000127

- 1800 171 386 Community information line open 24 hours
- sydneymetro@transport.nsw.gov.au
- Sydney Metro City & Southwest, PO Box K659, Haymarket NSW 1240
- If you need an interpreter, contact TIS National on 131 450 and ask them to call 1800 171 386